

## 8-9. SERVICE BRAKE ADJUSTMENT

### THIS TASK COVERS:

Service Brake Adjustment

### INITIAL SETUP

#### APPLICABLE MODELS

All

#### MATERIALS/PARTS

Lockwasher

#### REFERENCES (TM)

TM 9-2320-260-10

TM 9-2320-260-20P

#### EQUIPMENT CONDITION

- Parking brake set (TM 9-2320-260-10).
- Front or rear wheels removed (para. 9-3).
- Wheel bearing adjusted (para. 9-6).

### NOTE

- The front and rear brakes are adjusted the same way. This procedure covers the front brakes only.
- Allow brakes to cool before adjusting.

### Service Brake Adjustment

1. Remove nut (1), lockwasher (2), and inspection slot cover (3) from brakedrum (4). Discard lockwasher (2).
2. Turn brakedrum (4) to position inspection slot (5) at 8 o'clock location.
3. Loosen jamnut (10) on anchor pin (11) one full turn.
4. Turn anchor pin (11) clockwise or counterclockwise until gap between brakeshoe lining (7) and inner brakedrum surface (6) measures .010 in. (.25 mm).
5. Turn brakedrum (4) to position inspection slot (5) at 11 o'clock location.
6. Turn cam stud (9) clockwise until gap between brakeshoe lining (7) and inner brakedrum surface (6) measures .020 in. (.50 mm).
7. Turn brakedrum (4) to position inspection slot (5) at 5 o'clock location.
8. Loosen jamnut (12) on anchor pin (13) one full turn.
9. Turn anchor pin (13) clockwise or counterclockwise until gap between brakeshoe lining (7) and inner brakedrum surface (6) measure .010 in. (.25 mm).
10. Turn brakedrum (4) to position inspection slot (5) at 1 o'clock location.
11. Turn cam stud (8) counterclockwise until gap between brakeshoe lining (7) and inner brakedrum surface (6) measures .20 in. (.50 mm).
12. Install inspection slot cover (3) on brakedrum (4) with new lockwasher (2) and nut (1).
13. Turn brakedrum (4) by hand and turn cam stud (8) counterclockwise until brakedrum (4) drags. Loosen cam stud (8) until brakedrum (4) slightly drags.
14. Turn brakedrum (4) by hand and turn cam stud (9) clockwise until brakedrum (4) drags. Loosen cam stud (9) until brakedrum (4) slightly drags.
15. Repeat steps 1 through 14 to perform service brake adjustment of other wheel on axle.

**8-9. SERVICE BRAKE ADJUSTMENT (Contd)**

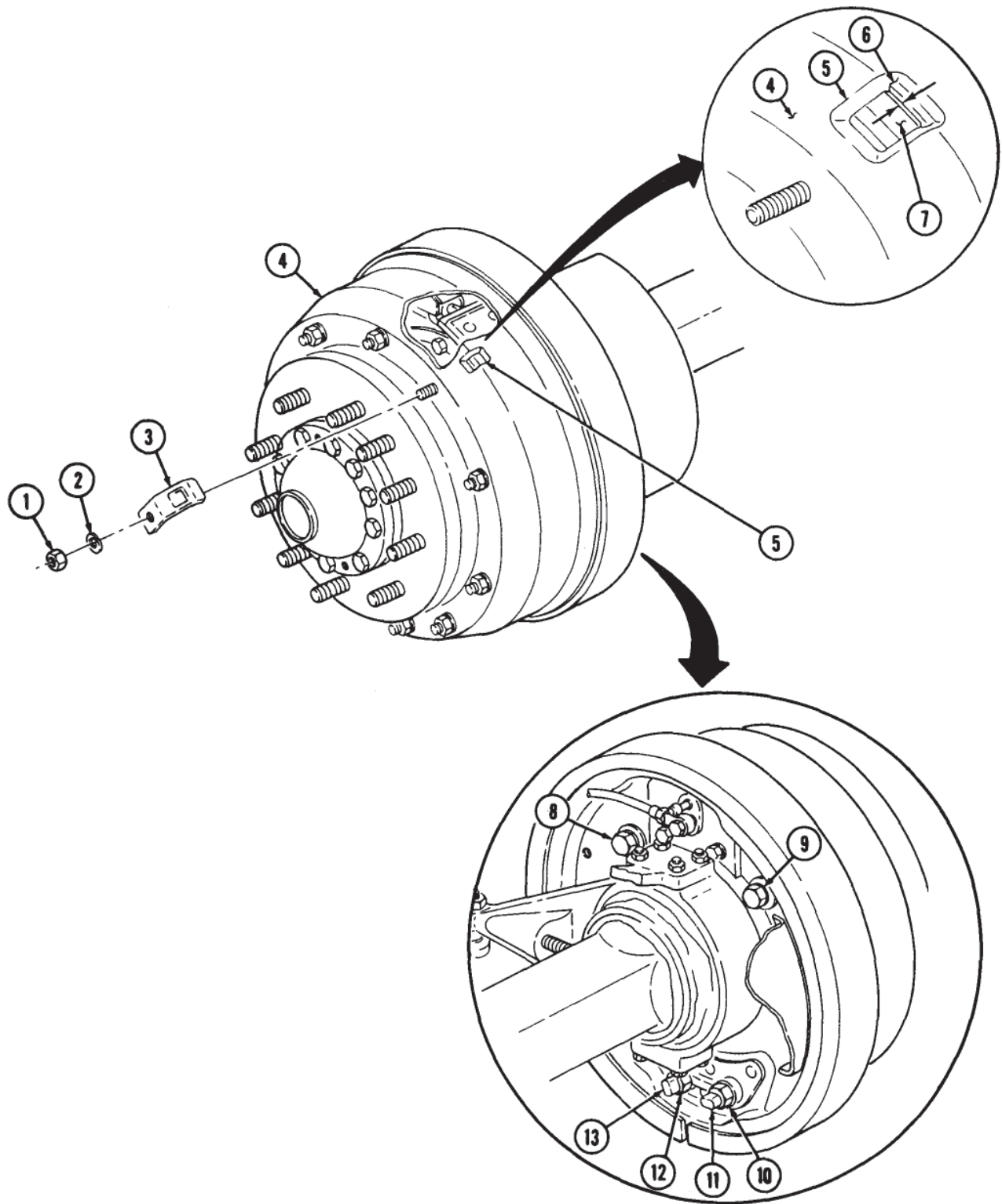

**FOLLOW-ON TASK:** Install front or rear wheels (para. 9-3).